



WEVER & DUCRÉ  
LIGHTING

# CENO 3.0

166461K3

Project	.....
Type	.....
Notes	.....
Quantity	.....
Date	.....

## GENERAL

Ceiling  
 Recessed  
 Jet Black + Gold  
 IP20  
 Interior  
 1340 lm

## LED

2700 K  
 CRI 90  
 L70 / 50000 h  
 3-step binning

## OPTICAL

Flood  
 Beam angle 35°

## PHYSICAL

Length 230 mm  
 Width 40 mm  
 Height 30 mm  
 0.39 kg  
 Tilt min 90°  
 Tilt max 90°  
 Rotation 350°

## ELECTRICAL

excl. power supply  
 27 V  
 Total connected power 22 W  
 LED Inset 19 W  
 700 mA  
 PC3  
 Safety distance 0.3 m

## CUTOUT

Length 221 mm  
 Width 32 mm  
 Min. ceiling thickness 8 mm  
 Max. ceiling thickness 25 mm  
 Recessed depth 60 mm

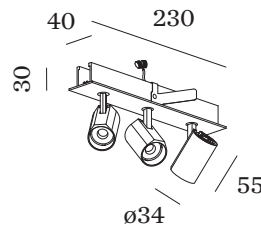

## LIGHT DISTRIBUTION

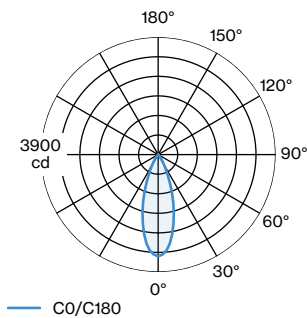

[166461K3] The technical data represent rated values for an ambient temperature of 25°C. The data values for the luminous flux are initially subject to a tolerance of +/- 10%, those for the electrical connected load are initially subject to a tolerance of +/- 10%, and those for the colour temperature are initially subject to a tolerance of +/- 150 K. No liability is assumed for typographical or printing errors. The general terms and conditions of Wever & Ducré BVBA apply.  
 © Wever & Ducré BVBA · Spinnerijstraat 99/21 · 8500 Kortrijk · Belgium · www.weverducre.com



WEVER & DUCRÉ  
LIGHTING

# CENO 3.0

166461K3

## CONE DIAGRAM

flood 35° 700mA

h (m)	EO <sup>2</sup> (lx)	ø (m)
1	3380	0.63
2	845	1.25
3	375	1.88
4	211	2.50
5	135	3.13

## Maintenance Factors

Operating Time [h]	10 000	20 000	30 000	40 000	50 000
LLMF	0.92	0.88	0.83	0.79	0.76
LSF	1	1	1	1	1

MF	LMF × RSMF × LLMF × LSF	RSMF <sup>a</sup>	Room Surface Maintenance Factor
MF	Maintenance Factor	LLMF	Lamp Lumens Maintenance Factor
LMF <sup>a</sup>	Luminaire Maintenance Factor	LSF	Lamp Survival Faktor

<sup>a</sup> According to "CIE 97, Maintenance of indoor electric lighting systems", 2005, ISBN 3-900-734-34-8. The values must be determined by the planner.

## ELECTRICAL

### Power Supply 700mA

TYPE	L · W · H (MM)	VOLTAGE	ORDERCODE
20W   16-28V   phase-cut dim	110·52·22		9 0 2 2 5 6 0 3
20W   dim	1376·44·30		9 0 2 2 5 6 0 4
20W   3-28V   DALI 0-100%	111·52·22	3-28V	9 0 2 4 5 6 0 2

## OPTICAL

### Honeycomb

TYPE	COLOUR	(MM)	ORDERCODE
CENO   PIRRO   BLIEK PETIT	Pure White	29	9 0 0 5 1 1 3 0
CENO   PIRRO   BLIEK PETIT	Signal Black	29	9 0 0 5 1 1 3 1



e29